

FOR LEASE

GREAT NEW SPACES AVAILABLE AT THE BLUE MALL!

150 Dorset Street, Suite 207 & 250, South Burlington, VT



New opportunities available at the Blue Mall in South Burlington! Suite 207 was in use as a retail space, and is available immediately. Suite 250 is currently the home of a primary eye care provider and is a highly visible location for retail or another service provider. Available September, 1 2026. The Blue Mall is a vibrant and busy strip center, located along the Dorset Street retail corridor in a prime location-ADT's are in excess of 30,000/day, and access is just off I-89 Exit 14.

SIZE:

Suite 207-1,840 +/- SF; Suite 250-1,800 +/- SF

PERMITTED USE:

Retail, service retail (office), restaurant, medical, recreational

AVAILABLE:

Immediately

PRICE:

\$19.00/SF, NNN, plus utilities
NNN charges @ \$9.50/SF

PARKING:

Ample, on-site

LOCATION:

Blue Mall - South Burlington

Information contained herein is believed to be accurate, but is not warranted. This is not a legally binding offer to sell or lease.



For more information, please contact:

YVES E BRADLEY

802-363-5696

yb@vtcommercial.com

208 FLYNN AVENUE, STUDIO 2i

BURLINGTON, VT 05401

www.vtcommercial.com







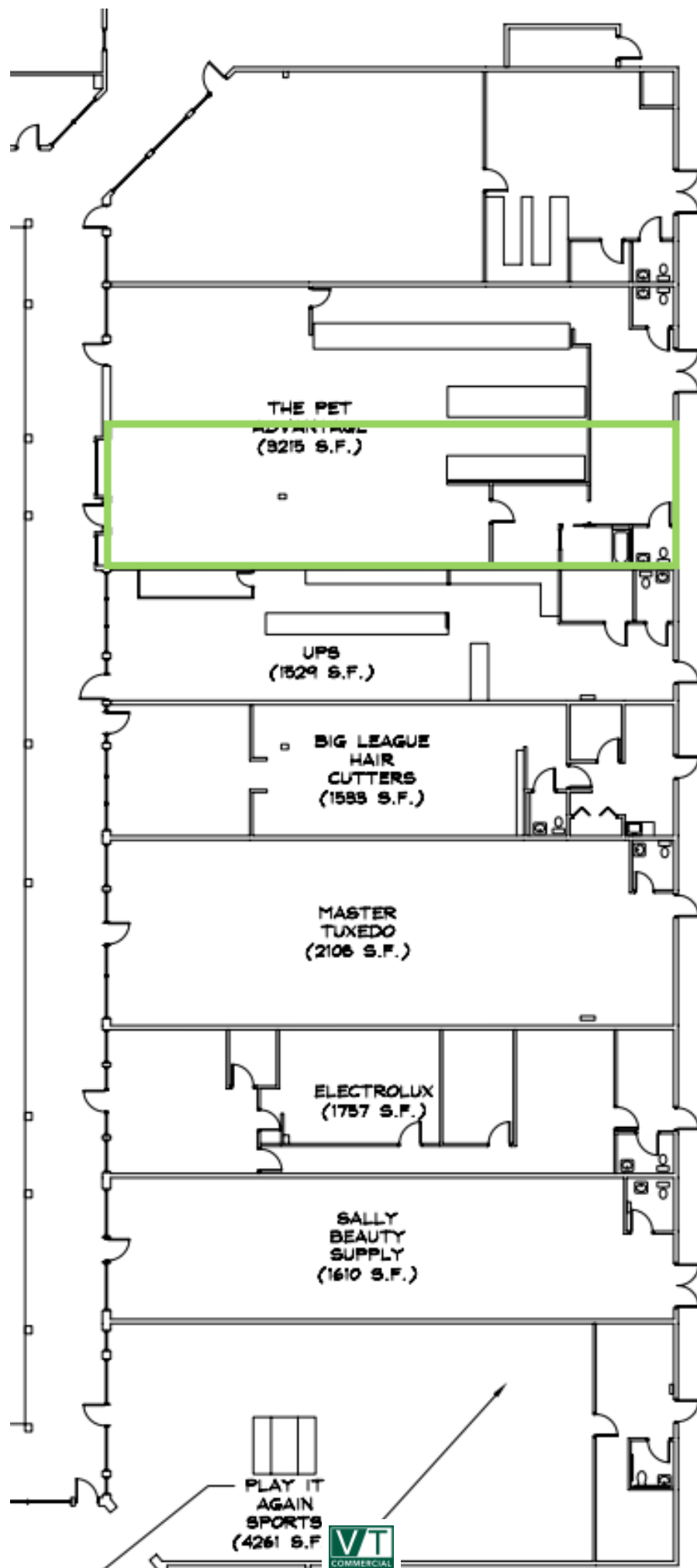

THE PET
RETAIL STORE
(3215 S.F.)

UPS
(1529 S.F.)

BIG LEAGUE
HAIR
CUTTERS
(1585 S.F.)

MASTER
TUXEDO
(2106 S.F.)

ELECTROLUX
(1757 S.F.)

SALLY
BEAUTY
SUPPLY
(1610 S.F.)

PLAY IT
AGAIN
SPORTS
(4261 S.F.)



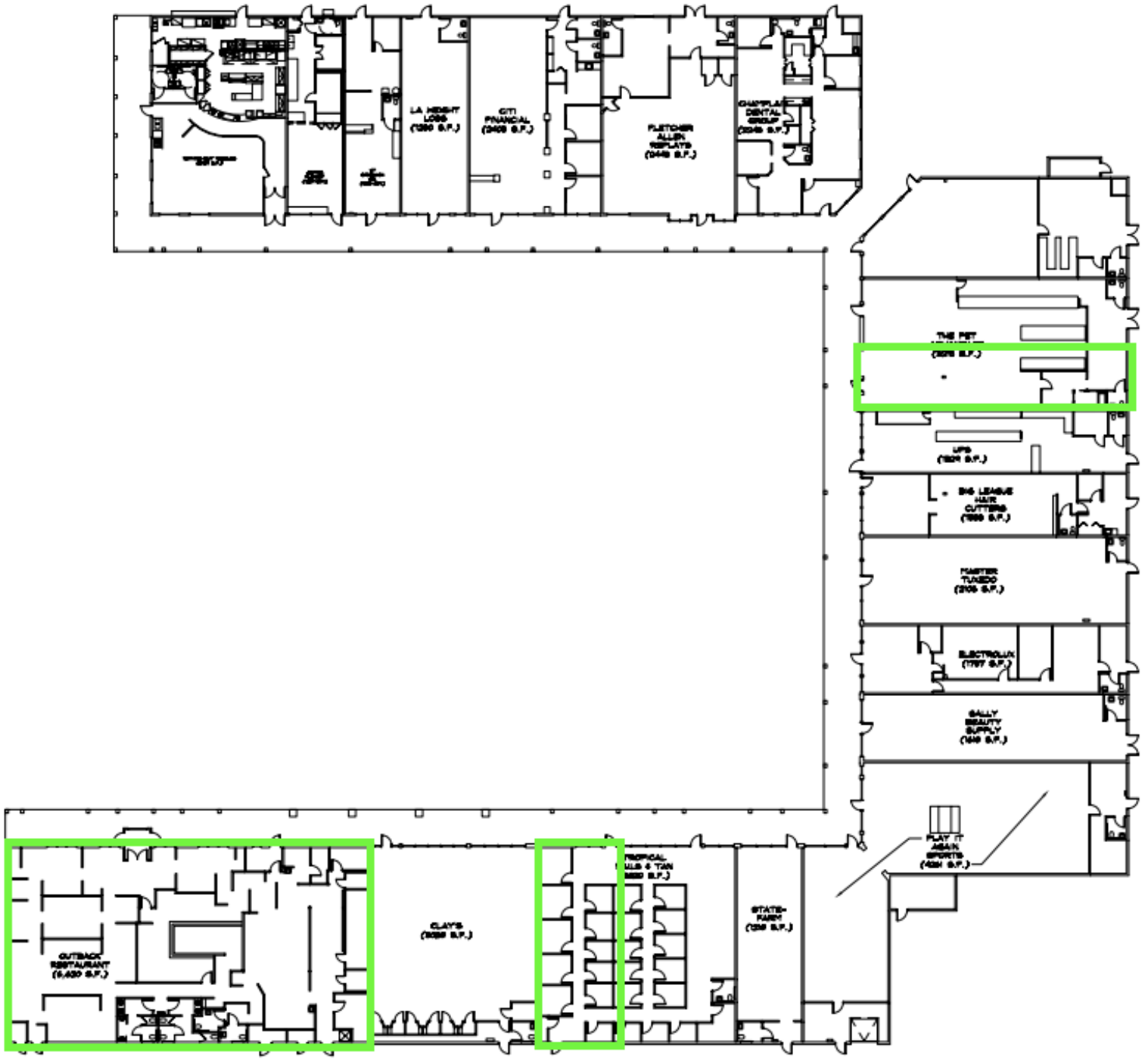

1 EXISTING FLOOR PLAN - OVERALL
1" = 20'-0"